

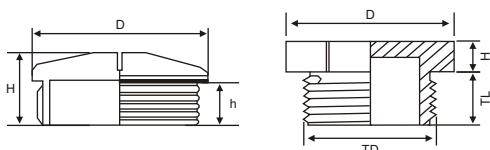

Blind Stops made of Polyamide 6 are used wherever threads previously cut must be closed for preventing dust, dirt and foreign matters from entering the enclosure or equipment. Flat washers of Neoprene are provided on the threaded part to get the IP 68 protection. Blind stops for explosion proof environment are also available.

Technical Details :	
Material	Polyamide 6
Colour	RAL 7001 (Grey) RAL 9005 (Black)
Threads available	Pg, Metric
Protection Class	IP 68
Temperature Range	-20°C to +80°C
Certificate No.	CESI 06 ATFX 034X
Approval	EEx e II - RAL 9005 (Black)



Pg Thread in Polyamide

Size	Cat. No. Grey	Cat. No. Black	H (mm)	D (mm)	h (mm)	Standard Pack (pieces)
Pg 7	BBS-01	BBS-21	8.0	15	4.5	50
Pg 9	BBS-02	BBS-22	9.0	19	4.5	50
Pg 11	BBS-03	BBS-23	9.0	22	4.5	50
Pg 13.5	BBS-04	BBS-24	9.5	25	4.5	50
Pg 16	BBS-05	BBS-25	9.5	27	4.5	50
Pg 21	BBS-06	BBS-26	11.0	33	6.0	50
Pg 29	BBS-07	BBS-27	12.0	44	6.0	50
Pg 36	BBS-08	BBS-28	15.0	55	8.0	50
Pg 42	BBS-09	BBS-29	16.0	62	8.0	50
Pg 48	BBS-10	BBS-30	16.0	69	10.0	50

Metric Thread in Polyamide

Size	Cat. No. Grey	Cat. No. Black	H (mm)	D (mm)	h (mm)	Standard Pack (pieces)
M 12 x 1.5	BMBS-0S	BMBS-2S	6	15	4.5	50
M 16 x 1.5	BMBS-01	BMBS-21	6	20	4.5	50
M 20 x 1.5	BMBS-02	BMBS-22	6	24	4.5	50
M 25 x 1.5	BMBS-03	BMBS-23	8	30	6.0	50
M 32 x 1.5	BMBS-04	BMBS-24	11	37	8.0	50
M 40 x 1.5	BMBS-05	BMBS-25	13	46	9.0	50
M 50 x 1.5	BMBS-06	BMBS-26	17	56	12.0	10
M 63 x 1.5	BMBS-07	BMBS-27	18	70	12.0	10

Metric Thread in Polyamide (Explosion Proof)

Size	Cat. No.	Thread Diameter TD (mm)	Thread Length TL (mm)	H (mm)	D (mm)	Standard Pack (pieces)
M 12 x 1.5	EBMBS-XS	12	10	5	17.5	50
M 16 x 1.5	EBMBS-X1	16	15	4.3	22	50
M 20 x 1.5	EBMBS-X2	20	15	6	26	50
M 25 x 1.5	EBMBS-X3	25	15	5.8	32	50
M 32 x 1.5	EBMBS-X4	32	15	7.8	41.5	10
M 40 x 1.5	EBMBS-X5	40	18	8.5	53	10
M 50 x 1.5	EBMBS-X6	50	18	9.5	63.5	10
M 63 x 1.5	EBMBS-X7	63	18	9.5	80	10

POLYAMIDE BLIND STOPS

STANDARD & EXPLOSION PROOF



STANDARD



EXPLOSION PROOF
Ex-E



Blind Stops made of Brass are used wherever threads previously cut must be closed for preventing dust, dirt and foreign matters from entering the enclosure or equipment.

Technical Details :	
Material	Brass, Nickel Plated
Temperature Range	-40° C to +135° C
Threads available	Pg, Metric

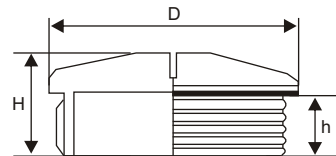

Pg Thread in Brass

Size	Cat. No.	H (mm)	D (mm)	h (mm)	Standard Pack (pieces)
Pg 7	SBBS-01	7	14	5	50
Pg 9	SBBS-02	8	17	5.5	50
Pg 11	SBBS-03	9	20	6	50
Pg 13.5	SBBS-04	9.5	22	6.5	50
Pg 16	SBBS-05	9.5	24	6.5	50
Pg 21	SBBS-06	11	30	7	50
Pg 29	SBBS-07	12	40	8	50
Pg 36	SBBS-08	14	50	9	50
Pg 42	SBBS-09	15	57	10	50
Pg 48	SBBS-10	15	64	10	50

Metric Thread in Brass

Size	Cat. No.	H (mm)	D (mm)	h (mm)	Standard Pack (pieces)
M 12 x 1.5	SMBBS-0S	7	14	5	100
M 16 x 1.5	SMBBS-01	8	18	5.5	100
M 20 x 1.5	SMBBS-02	9.5	22	6.5	50
M 25 x 1.5	SMBBS-03	10	27	7	50
M 32 x 1.5	SMBBS-04	11	35	7.5	25
M 40 x 1.5	SMBBS-05	12.5	44	8.5	25
M 50 x 1.5	SMBBS-06	14.5	54	9.5	25
M 63 x 1.5	SMBBS-07	15	67	10	25