



Bulk head mount housings are mounted over cut-outs in the electrical control panels where the conductors approach the inserts fixed inside the housings through the cut-outs.

Technical Details :

Material	Die cast Aluminium alloy
Protection Class	IP 66
Voltage	For Inserts upto 500V
Gasket	Vinyl Nitrile Elastomer (NBR)

Panel Cutout

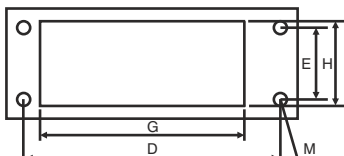
BULK HEAD MOUNT HOUSINGS
WITH 1 LEVER

Cat. No.	Enclosure Type	Enclosure Size (mm)	D (mm)	E (mm)	G (mm)	H (mm)	M (Ømm)
W06HB1/B6	6B	44 x 27	70	32	53	36	4.5
W10HB1/A10	10A	49 x 16	70	17.5	57	24	3.5
W10HB1/B10	10B	57 x 27	83	32	66.5	36	4.5
W16HB1/A16	16A	66 x 16	86	17.5	73	24	3.5
W16HB1/B16	16B	77 x 27	103	32	86.5	36	4.5
W24HB1/B24	24B	104 x 27	130	32	113	36	4.5
W32HB1/B32	32B	77 x 62	110	65	87.5	76.5	5.5
W48HB1/B48	48B	104 x 62	148	70	122.5	79.5	5.5