



Sliding type cable drag chains are used primarily for installations where long lengths of cable drag chain are required. In these type of drag chains it is necessary to provide support to the drag chain body with the help of a guide channel.

| Technical Details : | |
|---------------------|--|
| Chain Material | Glass fibre reinforced Polyamide, UL 94-HB |
| Noise | 55 dB (DIN EN 61672-1) |
| Applications | Gantry Robot, Machine Center, Textile Machine, Welding Machine, Wood Work Machine and Fabric Machine |
| Speed | 3m / sec |
| Temperature Range | -30° C to +130° C Continuous |
| Approvals | |



SLIDING TYPE CABLE DRAG CHAINS

(CPS036S SERIES)

CPS036S

| Bending Radius R | 70 | 90 | 120 | 150 |
|---------------------------|-----|-----|-----|-----|
| Lp | 500 | 564 | 664 | 759 |
| Lf | 260 | 330 | 375 | 540 |
| H | 100 | 100 | 100 | 100 |
| Technical Dimensions (mm) | | | | |

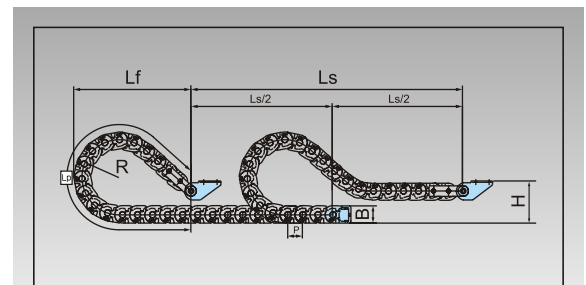

Ls : Stroke
Total Length L = Ls / 2 + Lp

Chain Cross Section

| Cat. No. | A | B | C | D | Bending Radius |
|-------------|-----|----|-----|----|------------------|
| CPS036S.35 | 67 | 41 | 35 | 28 | 70, 90, 120, 150 |
| CPS036S.55 | 87 | 41 | 55 | 28 | |
| CPS036S.75 | 107 | 41 | 75 | 28 | |
| CPS036S.100 | 132 | 41 | 100 | 28 | |

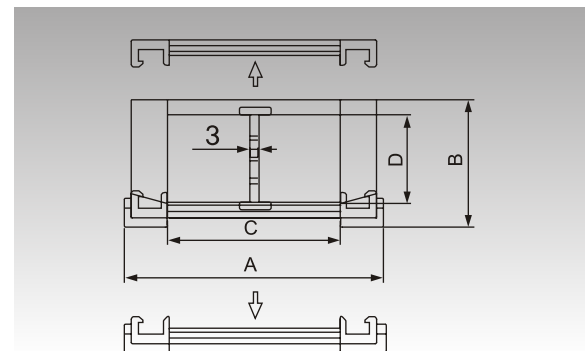

End Bracket (Steel)

| Cat. No. | End Bracket Type | Suitable for Chain Size | Fixed Point | Moving Point |
|---------------|------------------|-------------------------|-----------------|-----------------|
| EBS036S B1/B2 | Easy In Steel | CPS036S | 2-M5 Type Holes | 4-M5 Type Holes |

End Bracket Mounting Method

